

W Augusta E

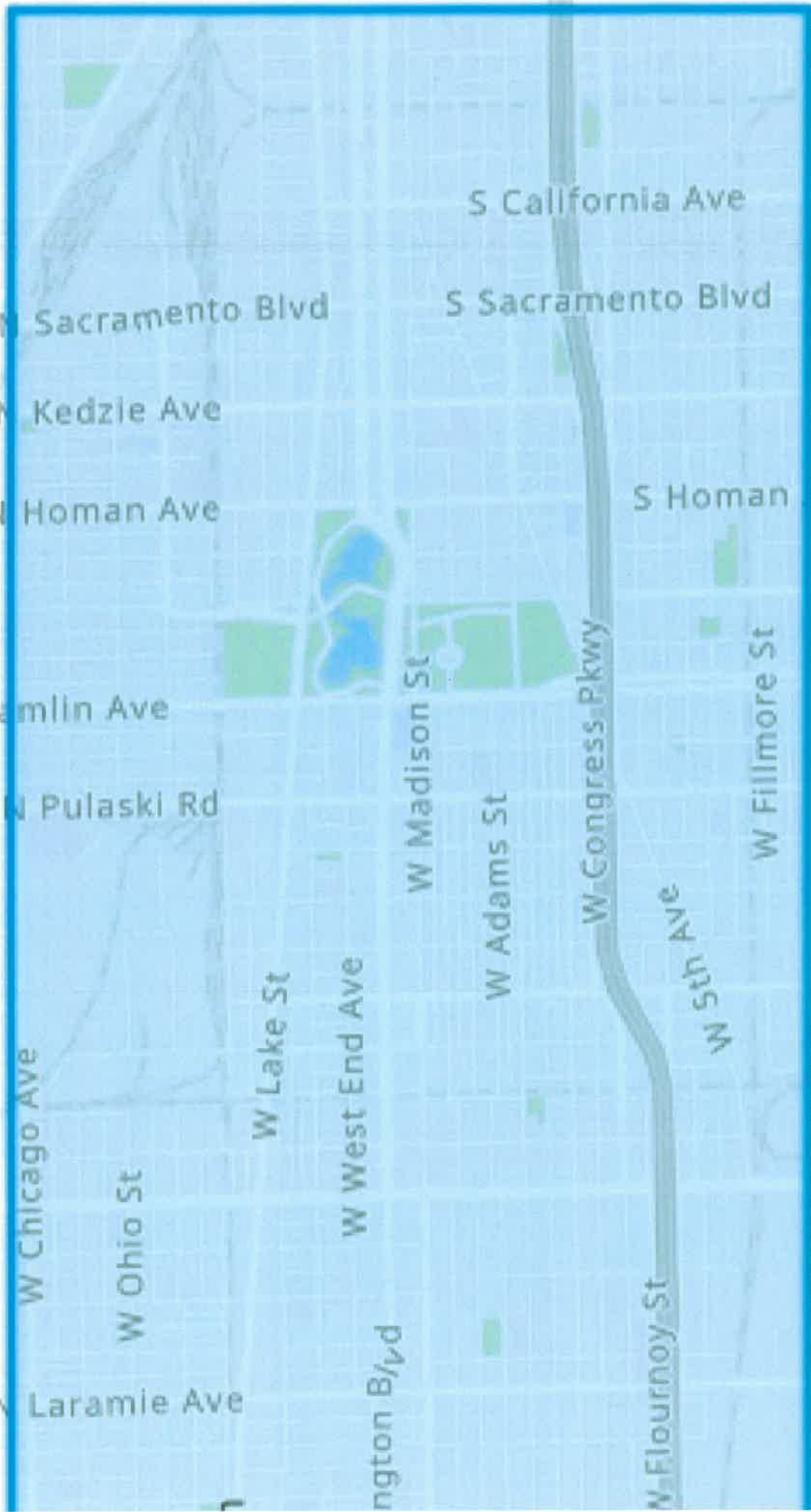

W Augusta Blvd

W Chicago Ave

W Ohio St

W Lake St

W West End Ave

W Madison St

W Adams St

W Congress Pkwy

W 5th Ave

W Fillmore St

W Roosevelt Rd

W 13th St

W 16th St

N Sacramento Blvd

N Kedzie Ave

N Homan Ave

N Hamlin Ave

N Pulaski Rd

S Sacramento Blvd

S California Ave

S Homan Ave

S Drak
S Centr

S Pulask

S Kostner

S Larami

S Kedzie

1100 25

2020 Census Redistricting Data (Public Law 94-171)

Wallace Wilbourn Jr.

36

The U.S. Census Bureau provides the 50 states, the District of Columbia, and Puerto Rico with population counts to use in their redrawing of congressional and state legislative district boundaries – a process known as “redistricting.”

2010-2020 ANNUAL GROWTH RATE



-0.15%
Population



-2.57%
Group Quarters



1.14%
Households

103,064
Total Population

45,021
Housing Units

KEY FACTS

11,321.9
Population Density

2.55
Average Household Size

42.2
Diversity Index

HOUSEHOLD POPULATION

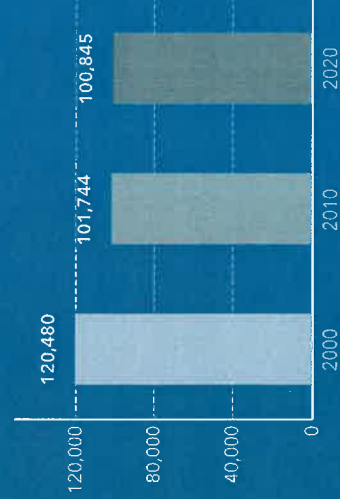

TOTAL POPULATION BY RACE

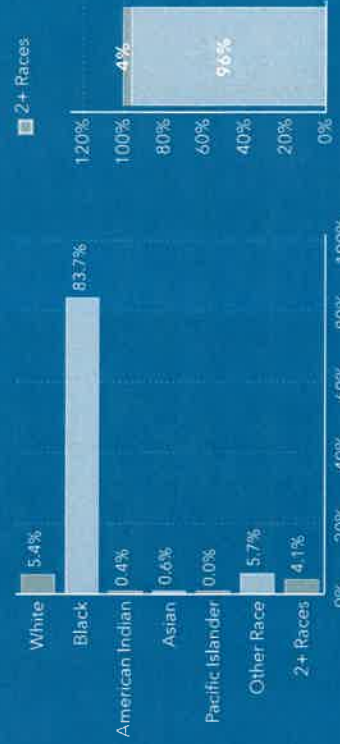

GROUP QUARTERS

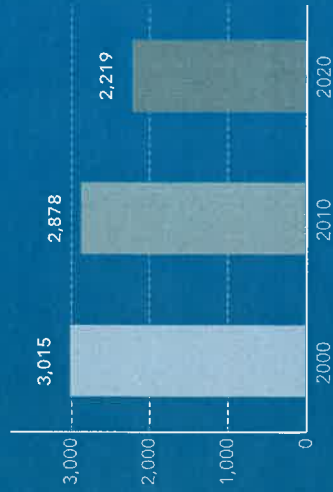

POPULATION BY AGE AND RACE	Less Than 18 Years	18 Years and Older
Total	25,989	77,075
1 Race	24,678	74,135
White	984	4,581
Black	21,685	64,592
American Indian/Alaska Native	109	308
Asian	102	550
Pacific Islander	8	30
Some Other Race	1,791	4,074
2 or More Races	1,311	2,940

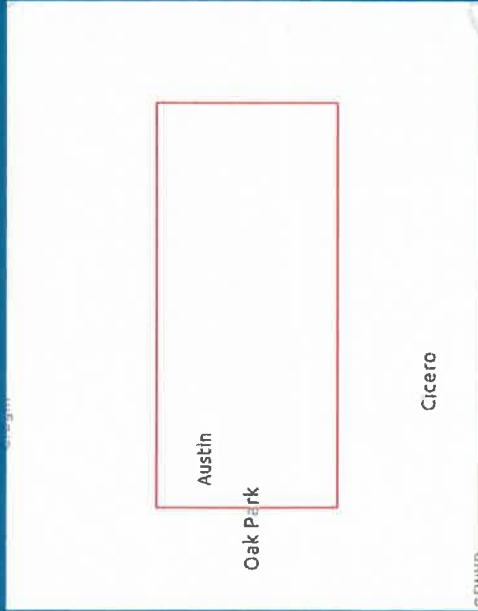

Source: U.S. Census Bureau, 2020 Redistricting Data (P.L. 94-171), U.S. Census Bureau 2010 decennial Census data converted by Esri into 2020 geography.



Source: This infographic contains data provided by U.S. Census, Esri. The vintage of the data is 2020, 2000, 2010.

2020 Census Redistricting Data (Public Law 94-171)

Wallace Wilbourn Jr.

36

The U.S. Census Bureau provides the 50 states, the District of Columbia, and Puerto Rico with population counts to use in their redrawing of congressional and state legislative district boundaries — a process known as “redistricting.”

GROUP QUARTERS BY POPULATION

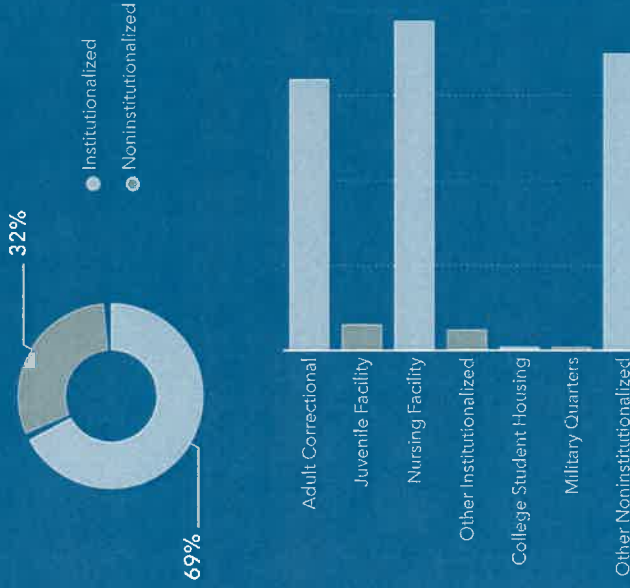

Source: U.S. Census Bureau, 2020 Redistricting Data (P.L. 94-171). U.S. Census Bureau 2010 decennial Census data converted by Esri into 2020 geography.



Source: This infographic contains data provided by U.S. Census, Esri. The vintage of the data is 2020, 2000, 2010.

KEY FACTS

103,064

Total Population

45,021

Housing Units

11,321.9

Population Density

2.55

Average Household Size

42.2

Diversity Index

HISPANIC POPULATION BY AGE AND RACE		Less Than 18 Years	18 Years and Older	Total
Total		3,470	7,123	10,593
1 Race		2,712	5,483	8,195
White		462	804	1,266
Black		453	531	983
American Indian/Alaska Native		82	197	279
Asian		10	34	44
Pacific Islander		1	17	18
Some Other Race		1,704	3,901	5,605
2 or More Races		758	1,640	2,398

NON-HISPANIC POPULATION BY AGE AND RACE		Less Than 18 Years	18 Years and Older	Total
Total		22,519	69,952	92,471
1 Race		21,967	68,652	90,619
White		522	3,777	4,299
Black		21,233	64,061	85,294
American Indian/Alaska Native		27	112	138
Asian		91	516	608
Pacific Islander		7	13	20
Some Other Race		87	173	260
2 or More Races		553	1,300	1,853

Wallace Wilbourn Jr. – Self

“Austin and Garfield Park are communities that were significantly impacted by the mass school closings of 2013. Representation is needed from these communities to advocate for communities with schools that are in need and that they be invested in rather than closed.”